



How To Order(型号表示方法)

SPS - ① 6 - ② M - ③ N

① Pad Diameter(吸盘直径)(mm)

用于SPFG		用于SPJG
6	25	6-J
8	30	8-J
10	35	10-J
15	40	15-J
20	50	20-J
		30-J
		40-J
		50-J

② Connection Thread(接管方式)

M	Male Thread(外螺纹)
F	Female Thread(内螺纹)

③ Pad Material(吸盘材料)

N	Nitrile Rubber(丁腈硅胶)
S	Silicone(硅胶)
NE	导电性丁腈硅胶
SE	导电性硅胶

Features(产品特点)

- Add inner teeth and outer teeth fixed screw to SPF and SPJ vacuum pad. It is easy to install.
- It is fit to suck small-sized steel plate, glass and so on.
- 在SPF、SPJ吸盘上附加内牙、外牙固定螺丝，安装简易。
- 适用于吸附小型钢板，玻璃等工件。

Dimensions(mm)(外形尺寸图(毫米))

Male Thread Connection(外螺纹连接) • SPS-M

Pad Diameters (适合吸盘直径)
Φ6 • Φ8 • Φ10

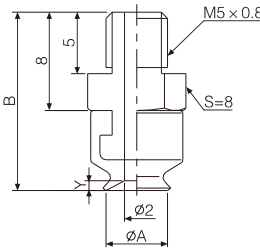

Pad Diameters (适合吸盘直径)
Φ15 • Φ20 • Φ25 • Φ30
Φ35 • Φ40 • Φ50

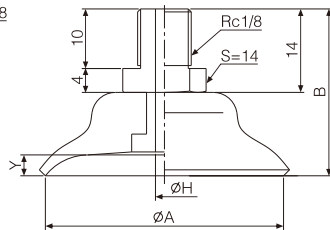

Pad Diameters (适合吸盘直径)
Φ6 • Φ8

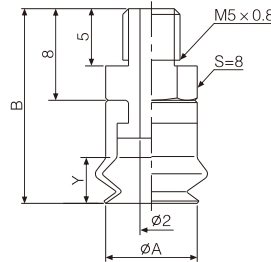

Pad Diameters (适合吸盘直径)
Φ10

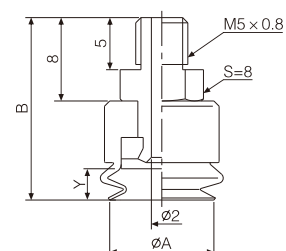

Pad Diameters (适合吸盘直径)
Φ15 Φ20 Φ30 Φ40 Φ50

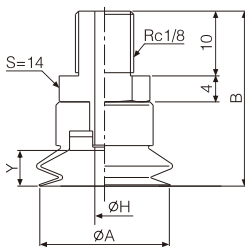

*SPS-F

Pad Diameters (适合吸盘直径)
Φ6 • Φ8 • Φ10

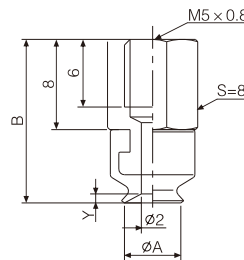

Pad Diameters (适合吸盘直径)
Φ15 Φ20 Φ25 Φ30
Φ35 Φ40 Φ50

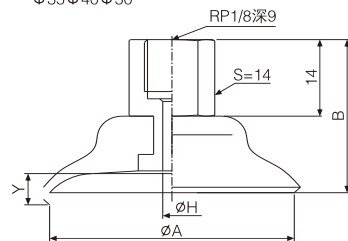

S:Width across flats(六角对边尺寸)

SPS(型号)	A	B	H	Y
SPS-6-M	6	14.5	-	0.8
SPS-8-M	8	15	-	1.2
SPS-10-M	10	15.5	-	1.5
SPS-15-M	15	22	2	1.9
SPS-20-M	20	24	3	2.3
SPS-25-M	25	28	3	3
SPS-30-M	30	26	3	2
SPS-35-M	35	28	3	3
SPS-40-M	40	28	3	3.5
SPS-50-M	50	29	4	4

SPS(型号)	A	B	H	Y
SPS-6-J-M	6	17	-	4.2
SPS-8-J-M	8	17	-	4
SPS-10-J-M	10	17.5	-	3
SPS-15-J-M	15	25	2	3.3
SPS-20-J-M	20	27	2	5.5
SPS-30-J-M	30	32	3	7
SPS-40-J-M	40	32	3	7.2
SPS-50-J-M	50	34	4	9

SPS(型号)	A	B	H	Y
SPS-30-F	30	26	3	2
SPS-35-F	35	28	3	3
SPS-40-F	40	28	3	3.5
SPS-50-F	50	29	4	4
SPS-6-F	6	14.5	-	0.8
SPS-8-F	8	15	-	1.2
SPS-10-F	10	15.5	-	1.5
SPS-15-F	15	22	2	1.9
SPS-20-F	20	24	3	2.3
SPS-25-F	25	28	3	3

吸盘附接头

Simple Vacuum Pad

AIRBEST Series

SPS Series

Dimensions(mm)(外形尺寸图(毫米))

Female Thread Connection(内螺纹链接)

• SPS-J-F

Pad Diameters (适合吸盘直径)
 $\Phi 6 \cdot \Phi 8$

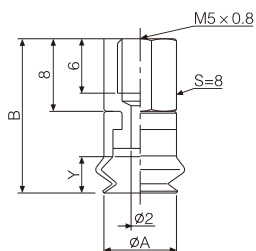

Pad Diameters (适合吸盘直径)
 $\Phi 10$

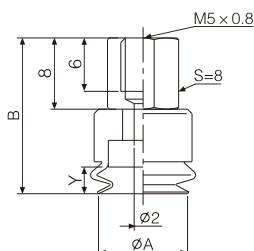

Pad Diameters (适合吸盘直径)
 $\Phi 15 \cdot \Phi 20 \cdot \Phi 30$
 $\Phi 40 \cdot \Phi 50$

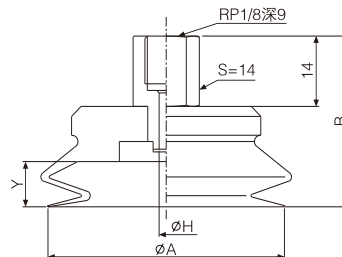

S:Width across flats(六角对边尺寸)

SPS(型号)	A	B	H	Y
SPS-6-J-F	6	17	-	4.2
SPS-8-J-F	8	17	-	4
SPS-10-J-F	10	17.5	-	3
SPS-15-J-F	15	25	2	3.3
SPS-20-J-F	20	27	3	5.5
SPS-30-J-F	30	32	3	7
SPS-40-J-F	40	32	3	7.2
SPS-50-J-F	50	34	4	9