

SOF Series



Applications(适用范围)

- Car stamped steel
- Steel plates with oily surface
- Long and narrow metal sheet parts
- Handling normal sheet metal (in order to avoid deformation)
- 汽车冲压钢板
- 油性表面类钢板
- 细长形金属板材
- 普通金属薄板搬运(防止变形)

Features(特征)

- Various sizes, suitable for workpiece with different shapes and sizes
- Large inner support structure, protects the metal sheets from deformation and damage during handling process
- Slot structure efficiently increases the friction force between vacuum pad and workpiece in order to prevent the oily metal sheets from slipping during the process of handling
- Flat, oval vacuum pad is suitable for long and narrow workpieces 1.5 bellows structure has good sealing and buffer to workpiece with uneven surface
- Vacuum pads are available with various connection types
- 尺寸型号齐全，适合不同形状和尺寸的工件
- 内部大面积支撑结构，能有效保护金属薄板在搬运过程中免于变形损伤
- 凹槽式内部支撑结构，有效增大吸盘与工件接触面摩擦力，防止油性金属板搬运过程中发生侧滑
- 扁平椭圆形接触面适合细长形金属板
- 吸盘有两种硬度可供选择(45和60)
- 吸盘有多种连接方式可供选择

Model(型号规格)

Model(型号)	Diameter(mm)(直径)	Material And Hardness(材质及硬度)	Connection Thread(连接螺纹规格)
SOF	20 × 80	N-45(Green)(N-NBR)	G1/4M (M-Male Thread)(M-外螺纹)
	30 × 90	N-45(绿色)(N-NBR)	G1/4F (F-Female Thread)(F-内螺纹)
	40 × 110	N-60(Orange)(N-NBR)	G3/8F
		N-60(橙色)(N-NBR)	M10M
			M14X1.5M
			RA Rectangular Tdapter(RA矩形适配器)

△SOF20X80N-60-G3/8F

Technical Parameters(性能参数)

Model(型号)	Vertical Pull-out Force (N) (垂直拉脱力)(N) -60kPa	Lateral Pull-out Force(N) (横向拉脱力)(N) -60kPa	Lateral Pull-Out Force On Oily Surface(N) (油性表面横向拉脱力)(N) -60kPa	Inner Volume(cm ³) (内部体积)	Min.Curve Radius of Workpiece(cm) (工件最小曲率半径)	Recommended Tube Diameter(mm) (推荐软管直径)	Weight(g) (重量)
SOF20X80	75	38	35	15	20	4	23
SOF30X90	120	77	60	18	25	6	24
SOF40X110	200	188	118	35	42	6	47

Dimensions(mm)(外形尺寸图(毫米))

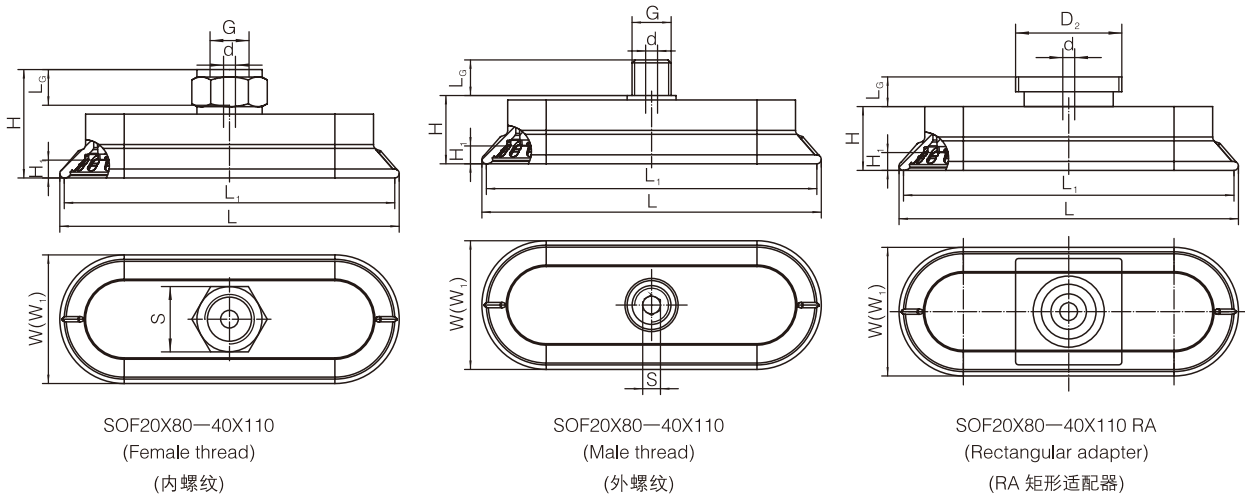

Model(型号)	Size (mm) (尺寸(毫米))		L	L ₁	W	W ₁	d	G	H	L ₆	D ₂	S	H ₁
SOF20X80N-45-G1/4F	84	82	84	82	24	22	6	G1/4F	29.5	11	--	20	5
SOF20X80N-45-G1/4M	84	82	84	82	24	22	6	G1/4M	17	12	--	6	5
SOF20X80N-45-G3/8F	84	82	84	82	24	22	6	G3/8F	29.5	11	--	22	5
SOF20X80N-45-M10M	84	82	84	82	24	22	4	M10M	17	12	--	4	5
SOF20X80N-45-M14M	84	82	84	82	24	22	6	M14X1.5M	17	12	--	6	5
SOF20X80N-45-RA	84	82	84	82	24	22	6	--	24.5	--	32	--	5
SOF30X90N-45-G1/4F	93	90	93	90	33	30	6	G1/4F	30	11	--	20	5
SOF30X90N-45-G1/4M	93	90	93	90	33	30	6	G1/4M	17.5	12	--	6	5
SOF30X90N-45-G3/8F	93	90	93	90	33	30	6	G3/8F	30	11	--	22	5
SOF30X90N-45-M10M	93	90	93	90	33	30	4	M10M	17.5	12	--	4	5
SOF30X90N-45-M14M	93	90	93	90	33	30	6	M14X1.5M	17.5	12	--	6	5
SOF30X90N-45-RA	93	90	93	90	33	30	6	--	25	--	32	--	5
SOF40X110N-45-G1/4F	113	110	113	110	43	40	6	G1/4F	35.5	11	--	20	6
SOF40X110N-45-G1/4M	113	110	113	110	43	40	6	G1/4M	23	12	--	6	6
SOF40X110N-45-G3/8F	113	110	113	110	43	40	6	G3/8F	35.5	11	--	22	6
SOF40X110N-45-M10M	113	110	113	110	43	40	4	M10M	23	12	--	4	6
SOF40X110N-45-M14M	113	110	113	110	43	40	6	M14X1.5M	23	12	--	6	6
SOF40X110N-45-RA	113	110	113	110	43	40	6	--	30.5	--	32	--	6